

# Flaherty Park Community Center

A TOWN OF WAKE FOREST PUBLIC FACILITY

1226 N. White St. | 919-554-6726  
 wakeforestnc.gov search "Flaherty Park Community Center"

## Facility Facts

**Year built:** 2002      **Parking:** large parking lot  
**Size:** 11,865 heated sq. ft.      on site  
**Property:** 100 acres

Flaherty Park Community Center is a recreational facility primarily used for Wake Forest Parks, Recreation & Cultural Resources Department programs. The center is open to citizens of all ages for open play basketball and volleyball. Visitors can also use the game room.

The center is located in J.B. Flaherty Park which encompasses 100 acres. The park includes ball fields, tennis courts, open space, a playground, a stocked pond, a dog park and picnic facilities.

**History:** In 1993, the town purchased 23 acres to build ball fields for its growing athletic program. Over the following years, the Flaherty family donated the rest of the 100 acres that are now J.B. Flaherty Park. In 2002, the town opened the community center which includes the first town-owned gymnasium.



## Amenities

- Regulation high school gymnasium
- Arts & crafts room
- Game room
- Meeting room with small kitchen

## Seating Capacities

- Meeting room: up to 24 seats
- Gymnasium: up to 912 seats

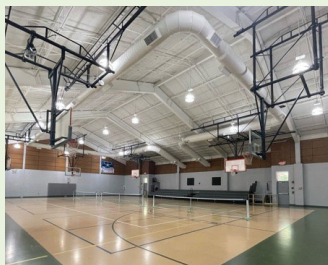

## Facility Rental Information & Fees

Rental Space	Deposit	Rental Rate	Non-Profit Rental Rate One (1) fundraiser allowed per calendar year. No alcohol.	Business Rental Rate One (1) for-profit event allowed per calendar year. No alcohol.	Active Military/ Veteran Rate
<b>Gymnasium</b>	\$150 \$350 business	\$150 hr   \$100 hr RD two hour minimum	\$112.50 hr   \$75 hr RD two hour minimum	\$300 hr   \$200 hr RD two hour minimum	\$135 hr   \$90 hr RD two hour minimum
<b>Meeting Room</b>	\$150 \$350 business	\$80 hr   \$50 hr RD two hour minimum	\$60 hr   \$40 hr RD two hour minimum	\$160 hr   \$100 hr RD two hour minimum	\$72 hr   \$45 hr RD two hour minimum

**After-hours Supervisory Fee** \$15 hr | Saturday 5 pm–midnight, Sunday 1 pm–midnight

**Days available:** Saturdays & Sundays\*

**Hours available:** 8 am–midnight

\*The center is temporarily closed on Sundays. Please call the center for the most current operating schedule and future availability.

To reserve the facility, call 919-554-6726.

The rental agreement, deposit, and full rental payment must be received a minimum of 10 business days prior to the requested rental date. Renter must be 21 years of age.

RD: Wake Forest resident discount



# Options for Seating Layout

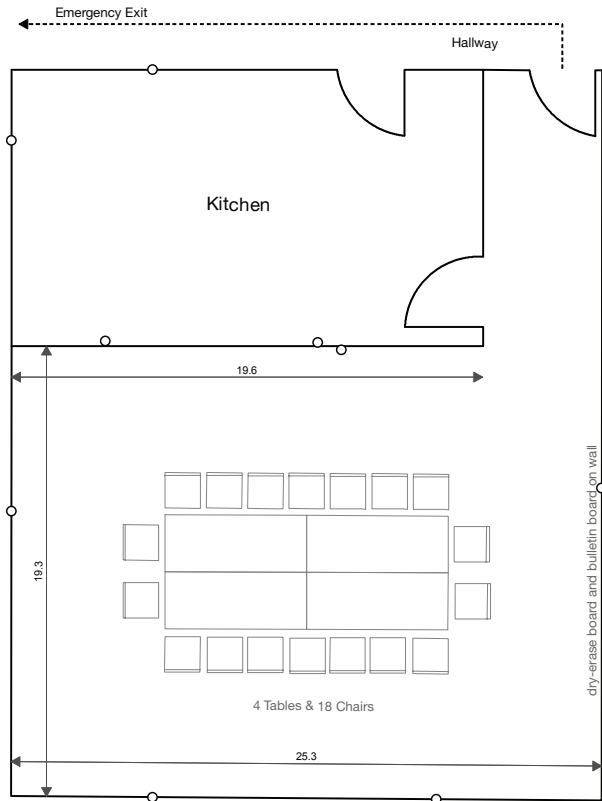

## Meeting

MAXIMUM SEATING: 18

Renters may select from one of the layouts shown here. These configurations abide by fire safety regulations and are ADA compliant. If you wish to adjust the layout, please consult with town staff first.

### Equipment Included in Rental—tables and chairs

- Renter will be responsible for all damage or misuse of the facility including repairs that exceed the deposit fee.
- Alcoholic beverages, intoxicating/controlled substances and smoking are prohibited.
- Nothing may be hung from, nor affixed to, light fixtures, nor tacked/stapled to walls and /or doors.
- No open flames of any kind.
- Any time needed for set up and clean up of rental is included in rental blocks.
- All trash must be removed off site.

## MEETING ROOM

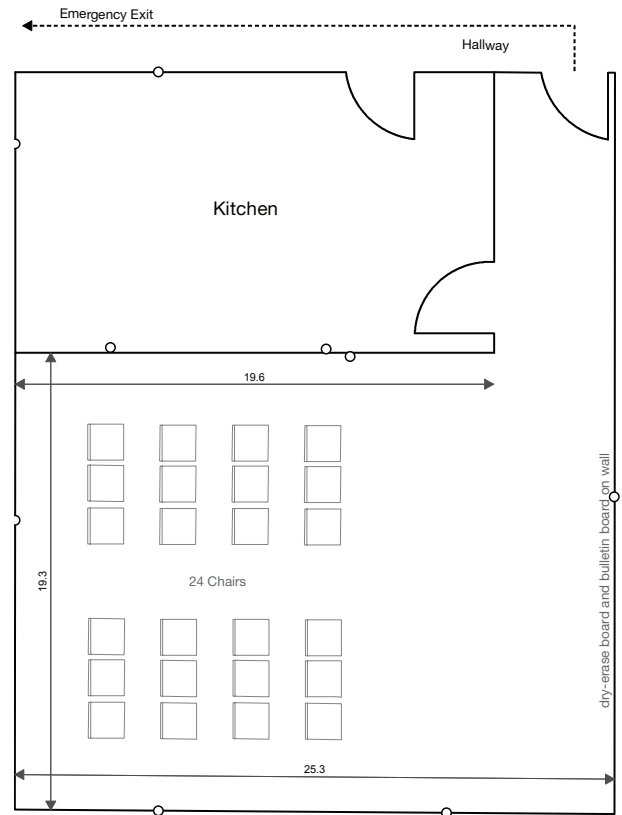

All dimensions in feet ○ = electrical outlet

## Presentation

MAXIMUM SEATING: 24

# Options for Seating Layout

## GYMNASIUM

### Banquet

MAXIMUM SEATING: 504

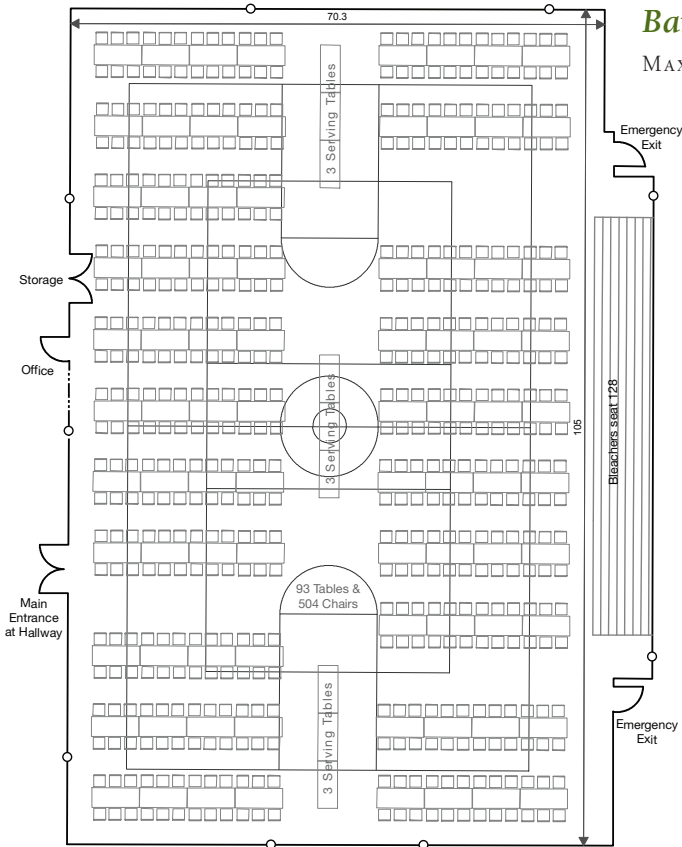

### Presentation A

MAXIMUM SEATING: 912

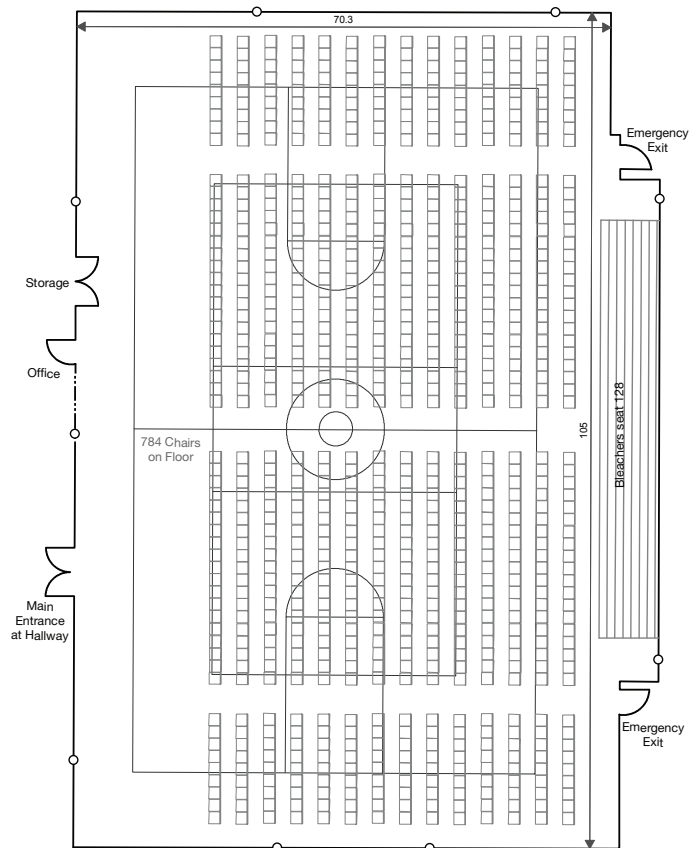

All dimensions in feet ○ = electrical outlet

- Renter is responsible for acquiring tables, chairs and any other furniture such as a podium with non-marking feet.
- The floorplans shown here were designed with tables measuring 6' x 2'6" and chairs measuring 18" x 18". Any differences in the actual furniture used may limit the capacity.

### Presentation B

MAXIMUM SEATING: 852

